

User's Manual
FOR USING UPDATE PACKAGES

INDEX

1	FOREWORD	3
2	SETTINGS TO ENABLE THE POP-UPS.....	5
2.1	If you have Chrome	5
2.1	If you have Firefox	7
2.2	If you have Internet Explorer.....	9
3	Using retailer/dealer packages	10

1 FOREWORD

The new databank website is formed by two different sections for wheel aligners and brake testers.

This manual is about the functionalities related to the wheel aligners and their data bases.

Any PC with an internet connection can access to the website functions.

When request, select the option “Wheel Aligner” to access the related functionalities.

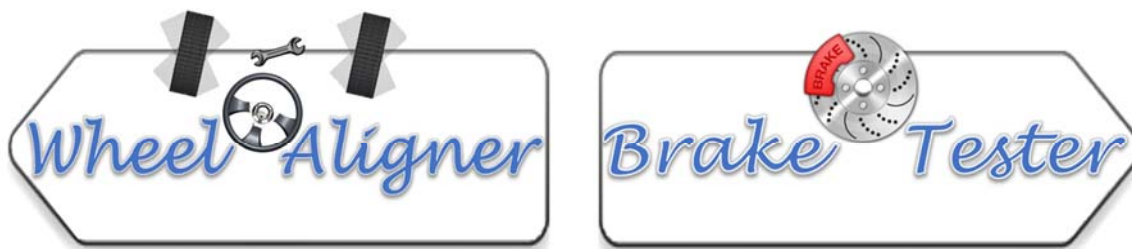

The home page of the wheel aligners section will open.

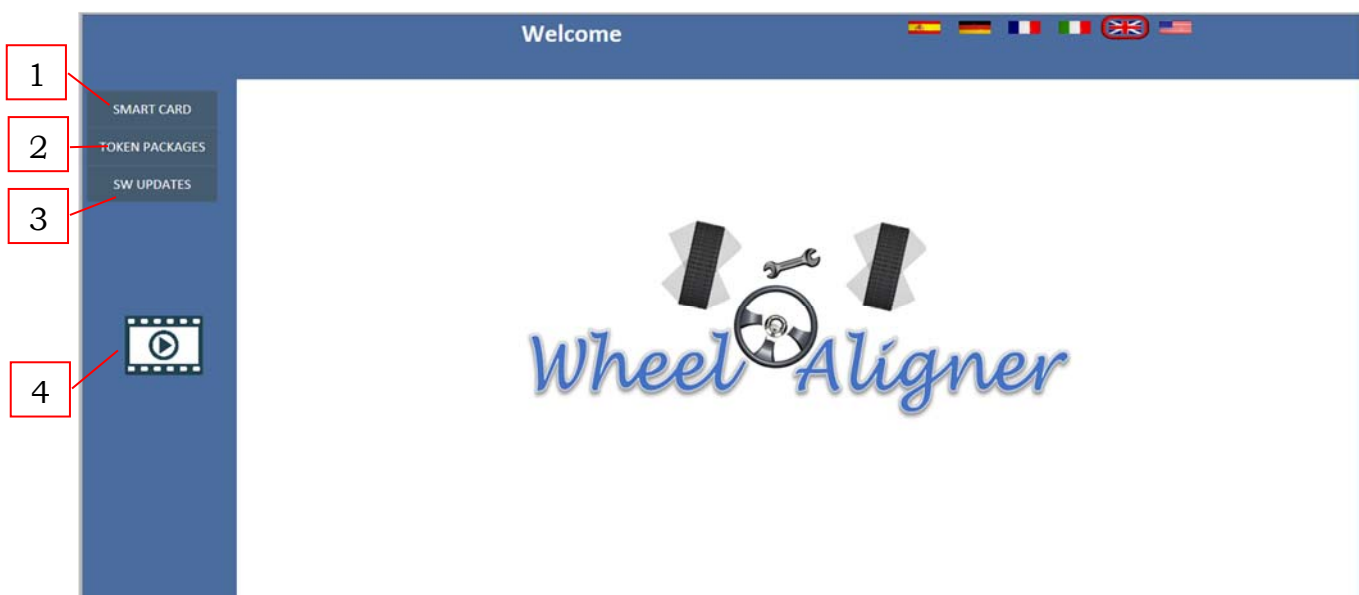

In the left side menu, it is possible to select the following operations:

1. **SMART CARD:** from here it is possible to download the token, the config and the databank to update or activate the aligner databank.
2. **TOKEN PACKAGES:** from here it is possible to access a reserved area, in which the tokens bought in a package can be linked with the desired smartcard. ID and PSW are sent when the purchase has been completed. This is the section that will be described in this manual.
3. **SW UPDATE:** to fully use the latest releases of the databank it is mandatory to always update the SW to the latest available version.
4. **VIDEO:** it's available a movie that shows how to activate, download and update the aligner data bank.

Select the option TOKEN PACKAGES to open the related section. The procedure to access the reserved area is described in chapter 3 of this manual.

In the left side menu, it will appear the option to download this manual and download it as a .pdf file in the selected languages (see ref. 5).

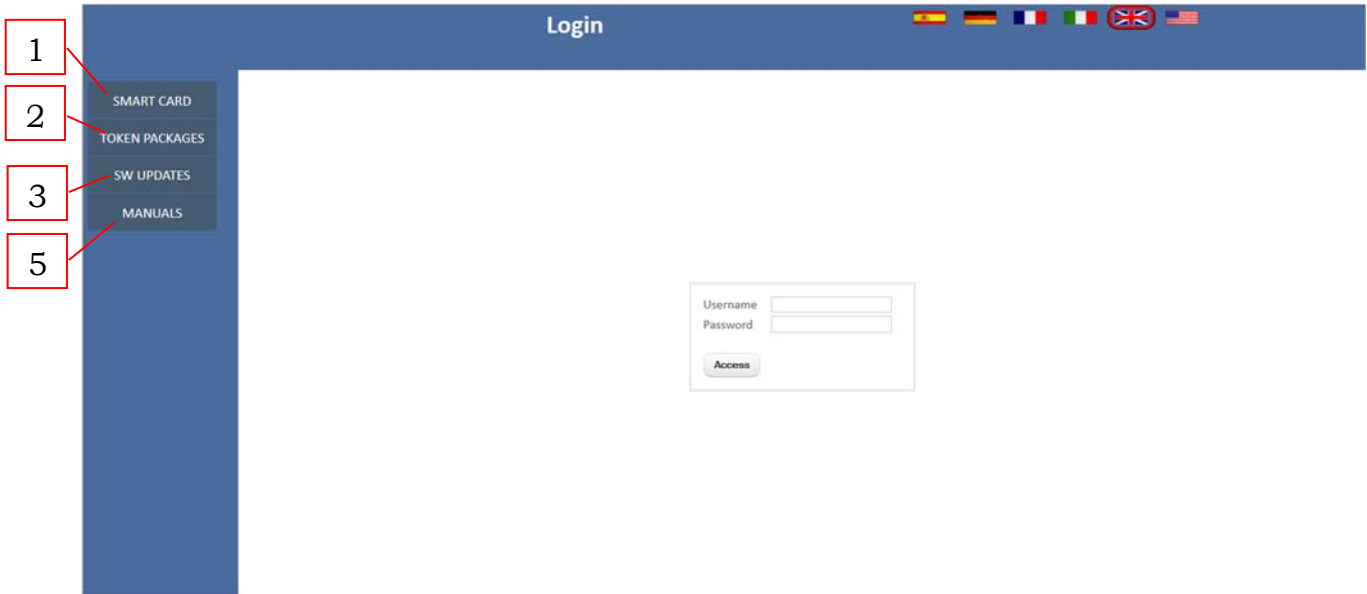

2 SETTINGS TO ENABLE THE POP-UPS

To download the files from the databank web site, POPUP must be enabled. The procedure to enable them varies depending on the browser you are using.

2.1 If you have Chrome

Select the Settings menu.

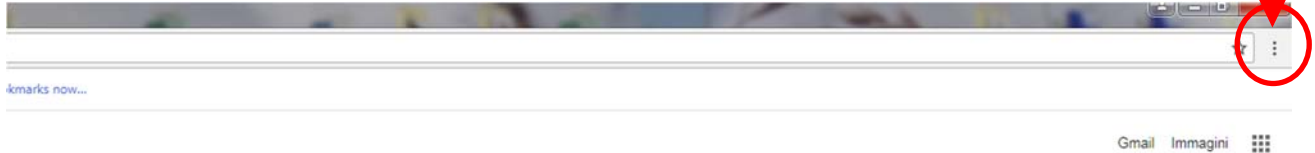

Select "Settings".

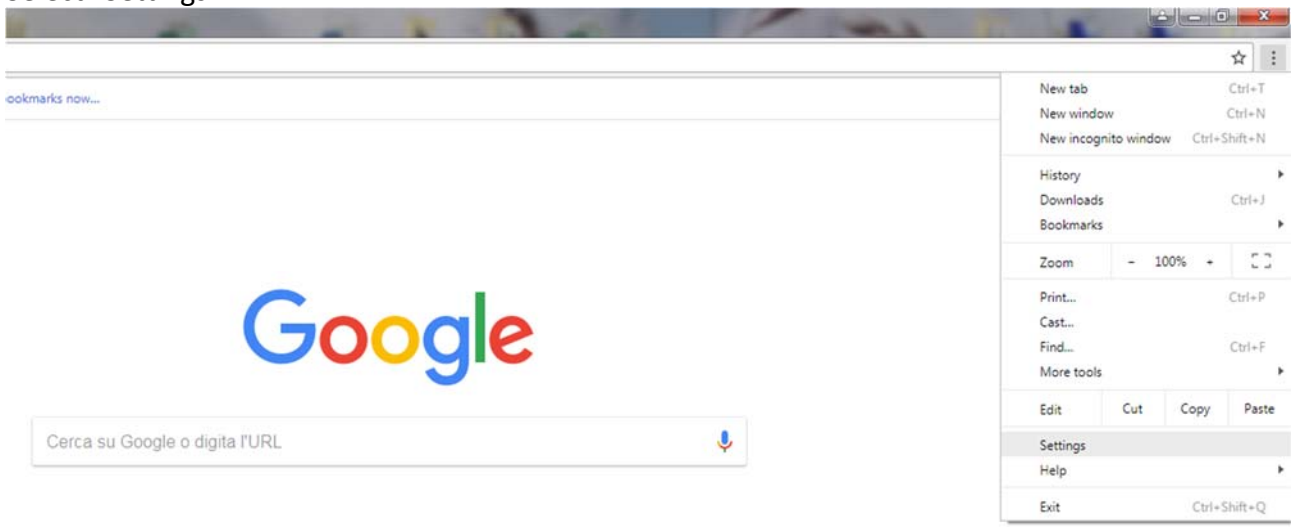

Select "Advanced".

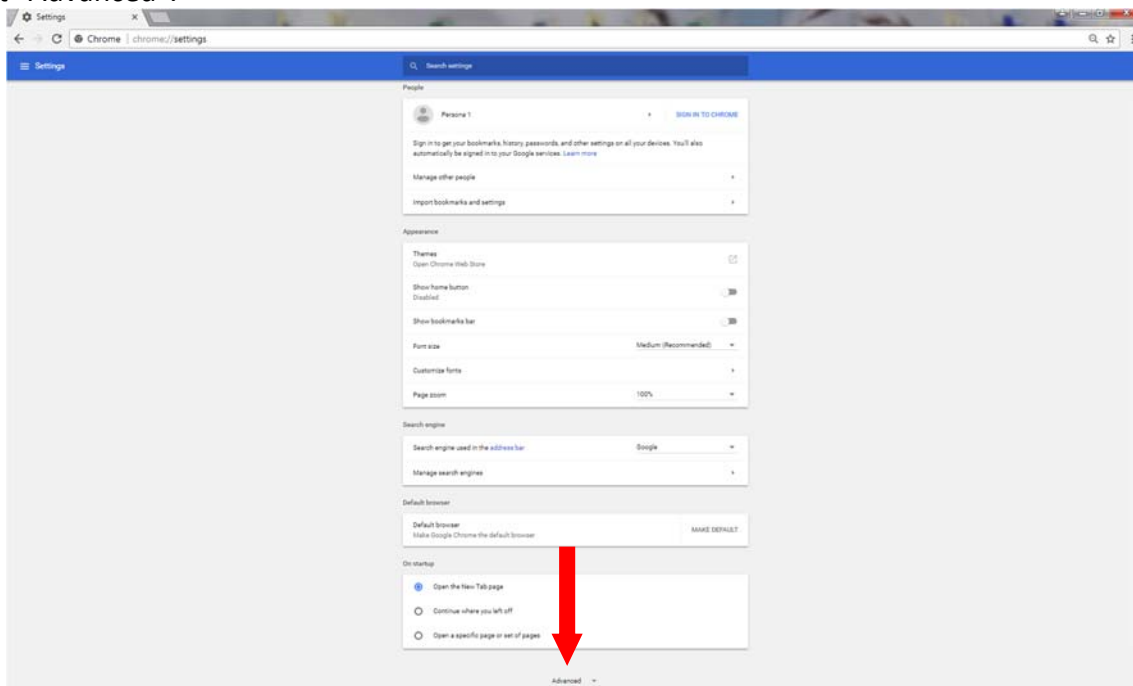

Scroll down to "Privacy and security" and select "Content Settings".

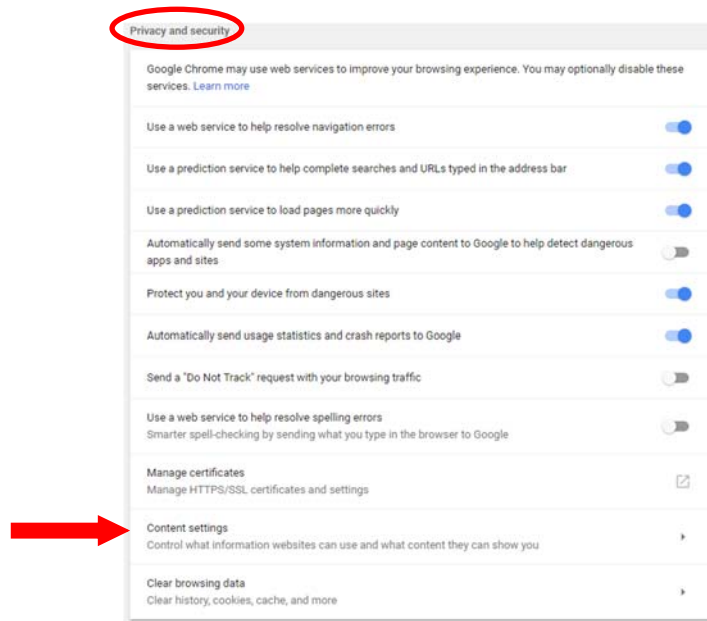

Scroll down to "Popup".

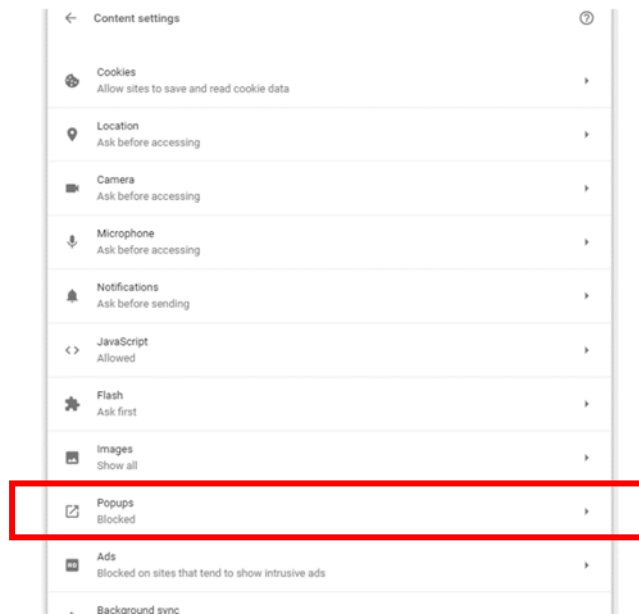

Select the option "Blocked" and change it in "Allowed".



Now you can download the token and the database.

2.1 If you have Firefox

Select the Settings menu.

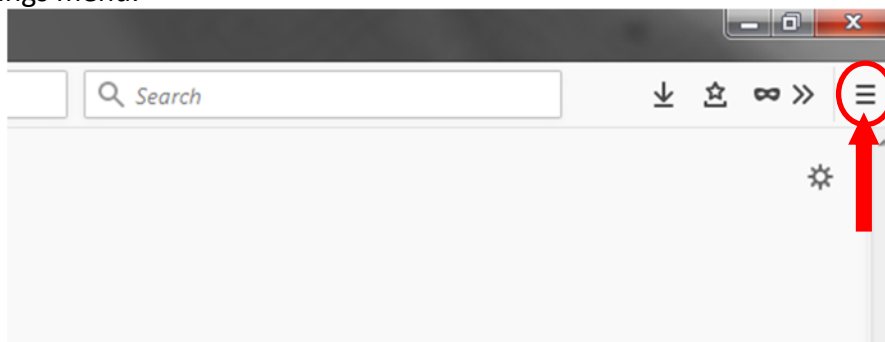

Select "Options".

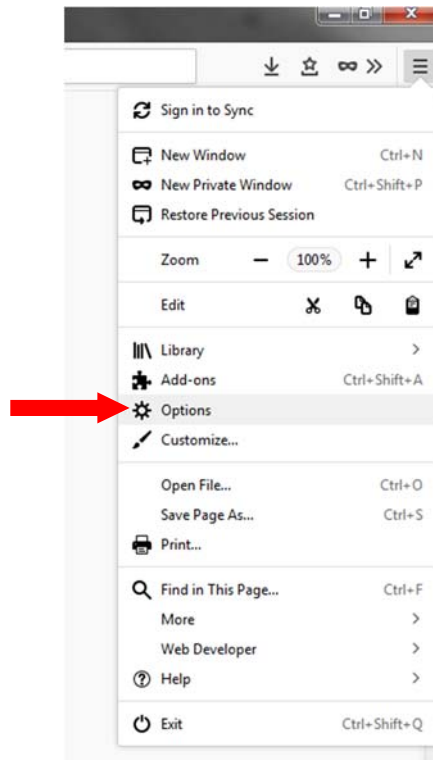

Select the "Privacy & Security" menu.

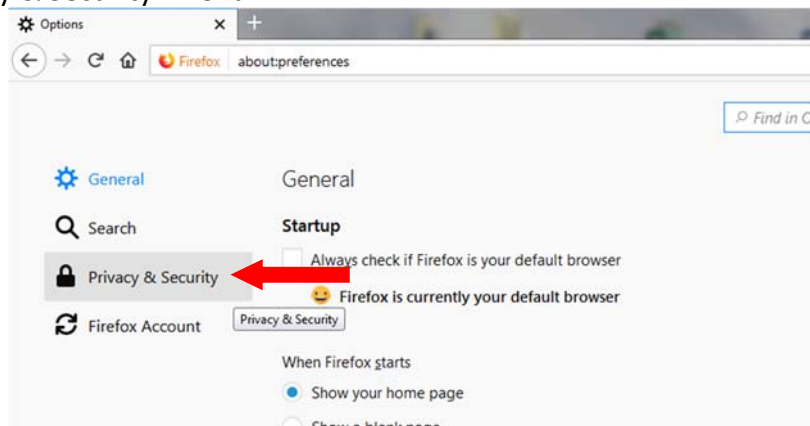

In the section "Permission", remove the check mark in "Block Pop-up windows".

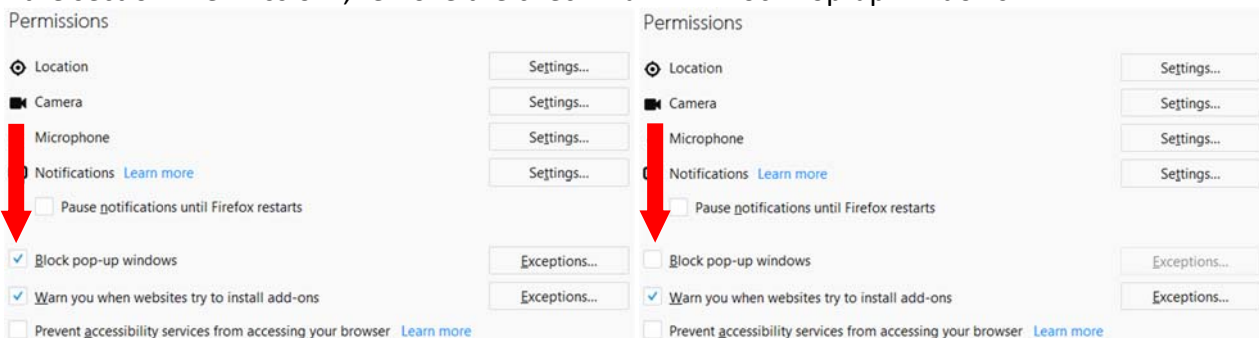

Now you can download the token and the database.

2.2 If you have Internet Explorer

Select the Settings menu.



Select "Internet Options".

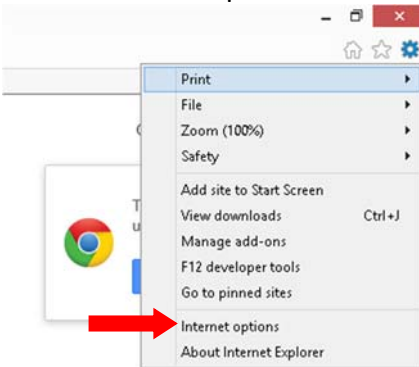

Select the "Privacy" tab.

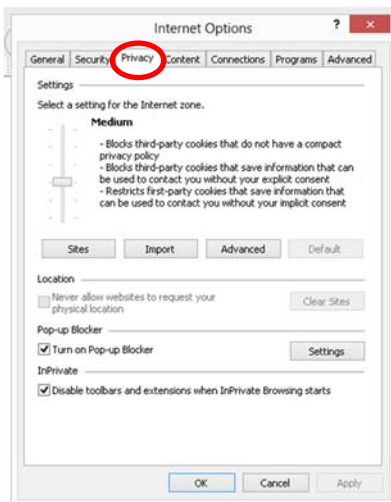

Remove the check mark in "Turn on Pop-up Blocker".

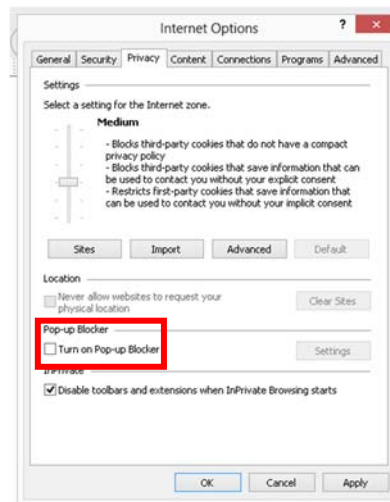

Click on "Apply" and confirm with "OK".
Now you can download the token and the database.

3 Using retailer/dealer packages



Enter the databank website highlighted on the SMART CARD.
The credentials to access the reserved area are sent via email when the order's been completed.
Here is an example of the email received from the dealer:



Pacchetto di update per prodotto STDA112 generato e pronto per il download
Grazie per avere usufruito dei servizi databank nel seguito le credenziali di accesso:

Up-date pack generated and ready for download
We thank you for having used our databank services; please find hereunder your access ID

Pack actualisation généré et pret pour le téléchargement
Nous vous remercions pour avoir utilisé nos services databank; de suite vos codes d'accès

Aktualisierungspack erzeugt und fertig fuer Downladen
Wir danken Ihnen, dass Sie unser Databank Service verwendet haben; bitte finden Sie hierunter Ihre Zugangskoden

Pack de actualisacion generado y listo para descargar
Gracias por haber utilizado nuestros servicios databank; aqui abajo Les confirmamos Sus codigos de acceso

username: pkupd000120
password: hcmb411td4o276

Select the TOKEN PACKAGES item from the left menu:

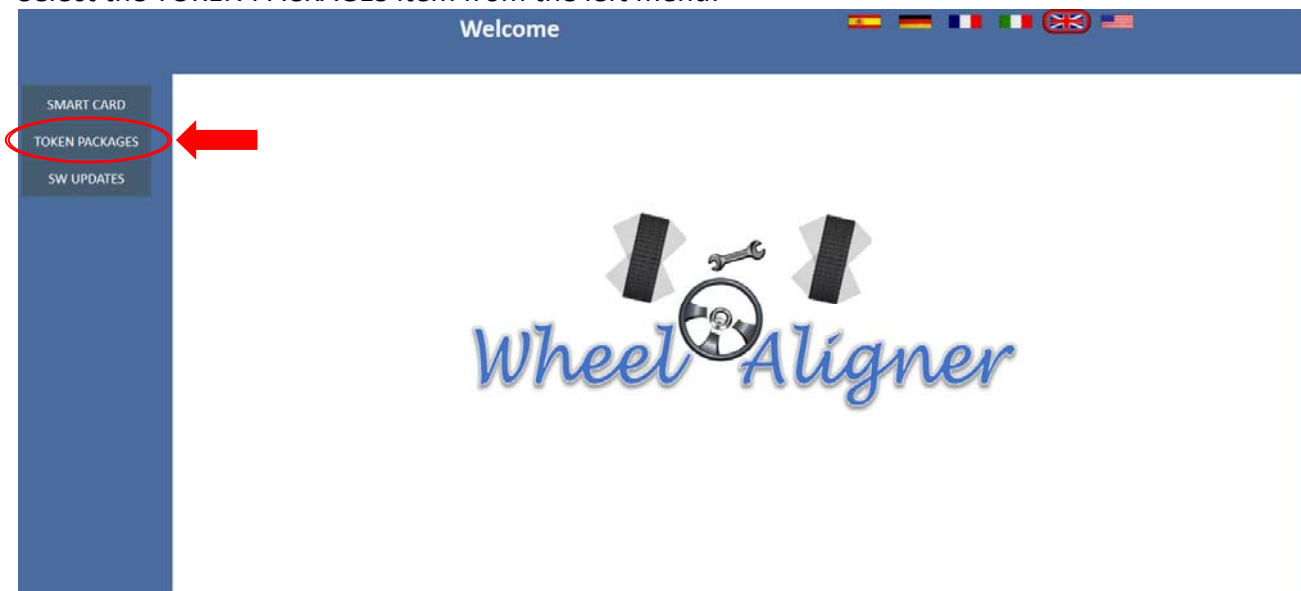

Enter the user name and password received

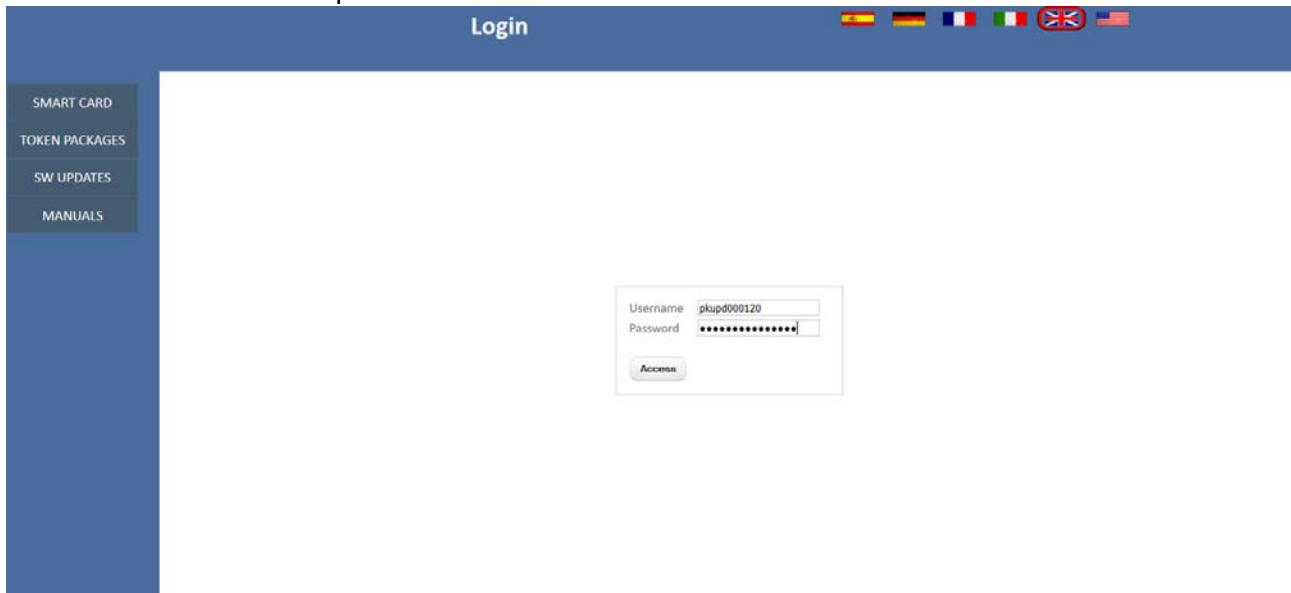

The dealer sees a summary page of the number of updates still to be used and the ones already used in the package.

In the left section of the screen, there are the information about the smartcard already paired to one of the token of the package.

In the right section of the screen, it's possible to pair a smartcard to one of the token still available in the package, so that the update can be generated for that same smartcard.



In case of purchase of very large packages, you can quickly search if a SMART CARD has already been paired. Enter the card number and click on Search.

Clicking on the link allows you to go to the Token download page.

Enter the number of cards you want to update and press the icon  to pair it to a token.

After pairing a smartcard to one of the available tokens, the dealer can go on with pairing another one in the same package or proceed with the download and installation of the update generated right now.

To proceed with the download and installation of the update, press on the smartcard number link in the list at the left side or choose the option "SMARTCARD" in the lateral menu on the left.

The procedure to download and install the update is described in the manual M0251, available in the section SMARTCARD.